

CD CHANG DER FIRE PROT. **TECHNICAL DATA** Water spray nozzle

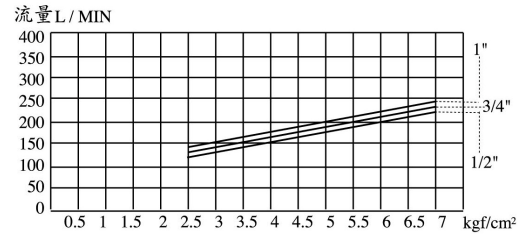
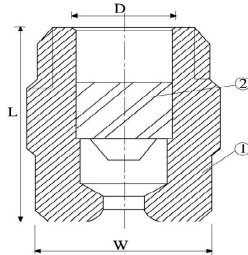

DESCRIPTION:

- The CD brand water spray nozzle makes a small particle spray pattern, cover the fire area, attack the fire.
- The water spray nozzle consists of full cone-shaped outlet body and helical nozzle insert, when spraying, the nozzle discharge forms a solid, full cone shaped with uniform distribution.
- The unit is use in indoor packing lot, large oil tank for fire protections

SPECIFICATIONS:

- Material: Brass with chrome plating
- Over all size:

Size	L	W	D
1"	53	Ø32.1	Ø22
3/4"	41.2	Ø27	Ø20
1/2"	42.7	Ø22	Ø15.2

- Performance:

model	size	thread of installation	radius, m	pressure kgf/cm ²	angle of discharge	flow rate lit/min	height of test, m
AHD202K	1"	PT1"	2.05~2.4	2.5~7.0	60,90,120°	138~238	2.5
AHD202H	3/4"	PT3/4"	1.95~2.3	2.5~7.0	60,90,120°	131~224	2.5
AHD202A	1/2"	PT1/2"	1.8~2.15	2.5~7.0	60,90,120°	126~211	2.5